

MCTS Western NAVWARN Issuing Desk

Website: nis.ccg-gcc.gc.ca

Phone: 250-627-3070

Email: NAVWARN.MCTSPrinceRupert@innav.gc.ca

Navigational Warning Request

Organization Name and Contact Number: Fraser Crossing Partners

Site Name and Contact Number:

FCCGP – Andrew Rodgers – Segment 1 Manager – arodgers@fcgp.ca – 604-319-2759

FCCGP – Nico Morin – Segment 2 Manager – nmorin@fcgp.ca – 604-341-3963

FCCGP – Shane Rodgers – Health & Safety Director – srodgers@fcgp.ca – 604-230-7690

FRPD – Jonathan Beamer – Superintendent – jbeamer@frpd.com – 778-792-1927

FRPD – Mike Honeyman – Superintendent – mhoneyman@frpd.com – 604-374-4629

FRPD – Mike Logan – Major Project Director – mlogan@frpd.com – 604-617-1541

Start Date and Time: May 11, 2026 – 06:00

End Date and Time: May 18, 2026 – 06:00

Location of Activity:

Pier N1 – Secondary (Domestic) Navigational Channel and Pier S1 – Main (Domestic) Navigational Channel

Fraser River upstream of the New Westminster Rail Bridge approximate Latitude 49 12' 30", Longitude 122 53' 32".

Brief Description of Work:

Overall stal was m (Riverview) Bridge Construction:

Overall finishing works on the stal was m (Riverview) Bridge are ongoing and may require work over parts of the Domestic Navigation Channel. TSOP must be followed. Flashing amber lights are in place for visual warning of overhead bridge works – please avoid the area with flashing lights.

Two temporary work platforms are currently in place on the underside of the main span – one over the main navigation channel and another at the far end of the span over the domestic navigation channel. A rolling underslung gantry platform is also in use to facilitate below-deck finishing works. The platform's access/egress point is located at the main S1 tower, and it will be used to travel back and forth across the underside of the bridge, including over both the Main and Domestic Navigation Channels throughout the day and night. As the work platform moves it is noted that, at its location, the platform will reduce vertical clearance by 3.65m. Please refer to the visual on page 3 for a cross section of these platforms.

Overall Pattullo Bridge Deconstruction:

Vertical props will be installed along Span 4 above the navigation channel to support arch lowering. Vertical props will reduce the vertical clearance for mariners by 0.6-1.8 m. Marine users should use extreme caution or avoid transiting below these works. Spotters are in place and in communication with machine operators to review marine transits in the vicinity. TSOP must be followed.

Positioning of barges in the area:

Please also be advised that FRPD-8 and the FRPD Stanley (or 2 barges of similar sizes) will be moored immediately south of the N1 pile cap within the administrative safety zone throughout the week. Aerial Work Platforms will be in use on the barges, and as such marine users are to use extreme caution to minimize wake when navigating passing through the bridge construction area. A tugboat will be assisting bridge works, and passing marine traffic is requested to communicate with the tugboat accordingly. **Slow bell: traffic to slow down to the following through the Pattullo Bridge Replacement Project area upstream and downstream to minimize wake:**

- 5 knots (10 km/hr) within 100 m of the shoreline; and,
- 10 knots (19 km/hr) beyond 100 m from shore.

Please refer to sketch on page 4.

Hours of Operation:

Up to 20 Hours per day (06:00 to 02:00).

Vessels on site:

- Tug assist vessel
- Barges: Capt Seymour, EM20, EM25, CTL1, Empire, Ocean Carrier, Ocean Trader, SE Trader, PT46, FRPD17 (FRPD, Subcontractor), NP20, FRPD McKenzie Derrick – 123' x 48', FRPD Barge – Empire XX – 200' x 50', FRPD GE2 Marine Crane, FRPD Stanley Barge
- Work Boat/Spotter C35406BC – (FCCGP)
- Catherwood towing vessels

VHF Channel Monitored

VHF channels to be monitored include:

- Channel 16 for the Canadian Coast Guard – **Emergency**
- Channel 74 for marine traffic in the Fraser River
- Channel 69 – FRPD Working Channel
- Channel 71 – FRPD Crew Working Channel

Special Requests or Additional Information

Occasional short-term interference of the downstream/upstream main and secondary navigational channel may be required between 06:00 to 21:00 within the Start and End Dates/Times to briefly move vessels across the river.

Tug assist available to assist transit of log tows chip barges, gravel barges, rock scows, through project site during in-water works. Contact VHF working channel 69 Marine Contractor Flagger to make request in accordance with stated 90-minute pre-call as per TSOP below.

Temporary Special Operating Procedures to be followed by Marine Traffic and Mariners.

| Temporary Special Operating Procedures (TSOP's) | Notice (minutes) | Communications | Communication Sequencing and VHF Channels |
|---|-------------------------|---------------------------|--|
| Pre-Call | 90 | Master Call Bridge Tender | Refer to Communications Flow Chart <ul style="list-style-type: none">• VHF Channel 74 General Information• VHF Working Channel 69 (Marine Contractor Marine Flagger)• VHF Channel 16 Emergency Channel |
| ETA Call | 30 | Master Call Bridge Tender | Refer to Communications Flow Chart <ul style="list-style-type: none">• VHF Channel 74 General Information• VHF Working Channel 69 (Marine Contractor Marine Flagger)• VHF Channel 16 Emergency Channel |
| The sequencing of actions and the VHF communication responsibilities are outlined in the Corresponding Temporary Special Operating Procedures | | | |



transportation
investment
corporation



PATTULLO BRIDGE
REPLACEMENT



NAVWARN – May 11 – May 18, 2026

CONSTRUCTION ACTIVITIES

Underslung gantry platform for finishing works.

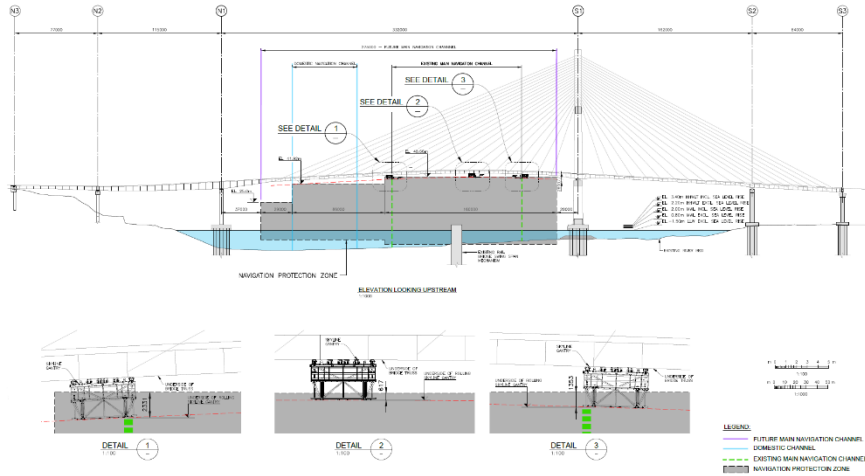

NAVIGATIONAL RESTRICTIONS

Flashing amber lights warning of transitioning works overhead; vertical clearance reduced by 3.65 m with gantry transitions.

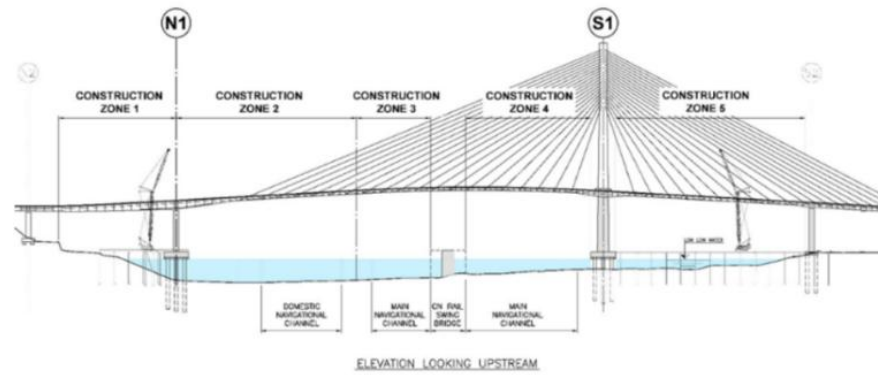



Marine Construction Weekly Update

| Period of May 11-May 18, 2026 | Zone 1 Pier N1 to New Westminster Shoreline (Administrative Safety Zone) | Zone 2 Domestic Navigation Channel | Zone 3 Main Navigation Channel - Upstream Draw | Zone 4 Main Navigation Channel - Downstream Draw | Zone 5 Pier S1 to Surrey Shoreline (Administrative Safety Zone) |
|-------------------------------|---|---------------------------------------|---|---|--|
| | | | | | |

- Open to All Marine Traffic
- Open with restricted manageability due to construction activities
- Closed due to construction activity

Contact the Project

 **24/7 Phone Line**
1-844-815-6149

 **Project Information**
pattullobridgereplacement.ca
pattullobridgeproject@gov.bc.ca

 **Marine Channels**
74 General Info
16 Marine Emergency

06 Marine Contractor
69 Tugs and Crews



NAVWARN – May 11 – May 18, 2026

DECONSTRUCTION ACTIVITIES

Installation of vertical props to support Span 4 steel truss removal.

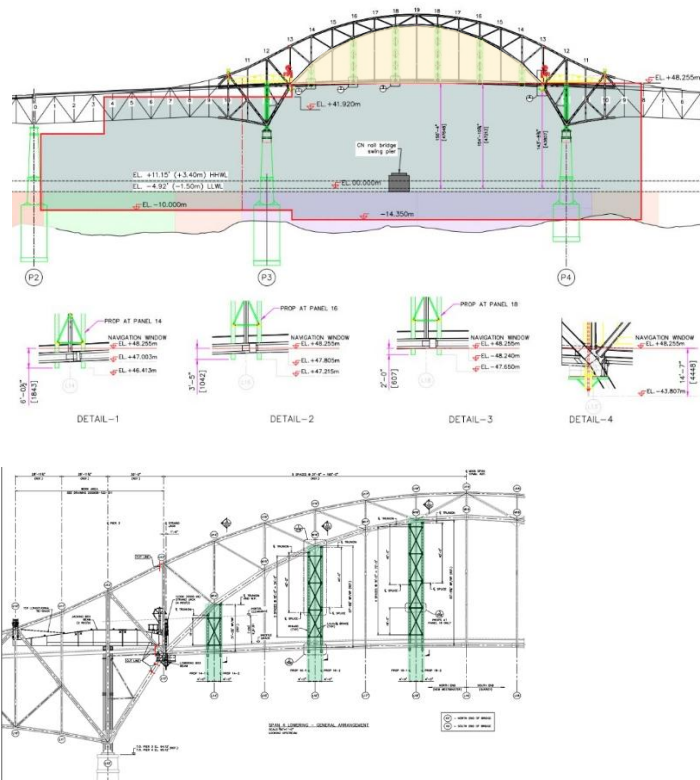

NAVIGATIONAL RESTRICTIONS

Works overhead; vertical clearance reduced by 0.6 to 1.8 m once props installed.

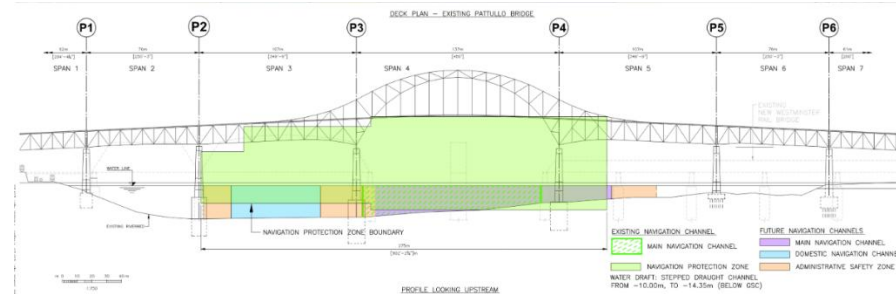

| | | | | | |
|---------------------------|--|---|---|---|--|
| Period of May 11-18, 2026 | Span 2 Piers P1 to P2 (Administrative Safety Zone) | Span 3 Piers P2 to P3 Domestic Navigation Channel | Span 4 (north) Piers P3 to P4 Main Navigation Channel - Upstream Draw | Span 4 (south) Piers P3 to P4 Main Navigation Channel - Downstream Draw | Span 5-6 Piers P5 to P6 (Administrative Safety Zone) |
|---------------------------|--|---|---|---|--|

- Open to all Marine Traffic
- Open with restricted manageability due to demolition activities
- Closed due to demolition activities

Contact the Project

24/7 Phone Line
1-844-815-6149

Project Information
pattullobridgereplacement.ca
pattullobridgeproject@gov.bc.ca

Marine Channels
74 General Info
16 Marine Emergency

06 Marine Contractor
69 Tugs and Crews