

MCTS Western NAVWARN Issuing Desk

Website: [nis.ccg-gcc.gc.ca](http://nis.ccg-gcc.gc.ca)

Phone: 250-627-3070

Email: [NAVWARN.MCTSPrinceRupert@innav.gc.ca](mailto:NAVWARN.MCTSPrinceRupert@innav.gc.ca)

---

# Navigational Warning Request

**Organization Name and Contact Number:** Fraser River Pile and Dredge (GP) Inc.

**Site Name and Contact Number:**

FRPD – Dan Townrow – Superintendent – [dtownrow@frpd.com](mailto:dtownrow@frpd.com) – 778-791-0541

FRPD – Ryan Pilgrim – Superintendent – [rpilgrim@frpd.com](mailto:rpilgrim@frpd.com) – 604-374-6321

FRPD – Mike Honeyman – Superintendent – [mhoneyman@frpd.com](mailto:mhoneyman@frpd.com) – 604-374-4629

FRPD – Mike Logan – Project Director – [mlogan@frpd.com](mailto:mlogan@frpd.com) – 604-362-7464

FRPD – Joe Lagos – Health and Safety Coordinator – [mlagos@frpd.com](mailto:mlagos@frpd.com) – 778-873-6725

**Start Date and Time:** Jan 23, 2024 – 10:00

**End Date and Time:** Jan 31, 2024 – 19:00 (Weekly issuance) *Or amended due to change in work activities.*

**Location of Activity:**

**Fraser River Rail Bridge – Pier 5 – Downstream Draw – Main Navigational Channel**

Fraser River upstream of the New Westminster Rail Bridge approximate Latitude 49 12' 30", Longitude 122 53' 32". S1 Pier of the new Pattullo Bridge.

**Brief Description of Work:**

Scour intervention material placement on swing bridge Pier 5 of the Fraser River Rail Bridge is set to commence. Works include install of rip rap rock materials to secure scour areas near Pier 5.

Works will start in the Downstream Main Swing Bridge Draw (Surrey side of Swing Bridge).

**Hours of Operation:**

10 to 12 Hours per day – 6 days per week.

Closure/restriction of the downstream main navigational channel may occur between 0600 to 1900 – Monday to Saturday.

**Vessels on Site:**

FRPD McKenzie Derrick – 123' x 48' x 8'

FRPD No. 12 Barge – Rip Rap Material.

Catherwood Towing or other 3rd party tug boats x 2.

**VHF Channel Monitored:**

VHF channels to be monitored include:

- Channel 16 for the Canadian Coast Guard – **Emergency**
- Channel 74 for marine traffic in the Fraser River.
- Channel 69 – FRPD Crew(s) Working Channel
- Channel 71 – Alternate FRPD Crew Working Channel

**Special Requests or Additional Information**

Reference is made to the attached staging drawing for works Jan 23 to Jan 31, 2024.

**Downstream Main Navigation Channel will be blocked during the active working times. Counter transit procedures through the upstream main draw required.** Upstream main channel and auxiliary channel will be open. Counter transit of the main navigational channel will be required.

**Temporary Special Operating Procedures to be followed by Marine Traffic and Mariners.**

Temporary Special Operating Procedures (TSOP's)	Notice (minutes)	Communications	Communication Sequencing and VHF Channels
Pre-Call	60	Master Call Bridge Tender	Refer to Communications Flow Chart <ul style="list-style-type: none"><li>• VHF Channel 74 General Information</li><li>• VHF Working Channel 69 (Marine Contractor Marine Flagger)</li><li>• VHF Channel 16 Emergency Channel</li></ul>
ETA Call	20	Master Call Bridge Tender	Refer to Communications Flow Chart <ul style="list-style-type: none"><li>• VHF Channel 74 General Information</li><li>• VHF Working Channel 69 (Marine Contractor Marine Flagger)</li><li>• VHF Channel 16 Emergency Channel</li></ul>

The sequencing of actions and the VHF communication responsibilities are outlined in the Corresponding Temporary Special Operating Procedures

Reference is also made to the attached Marine Communications Flow Chart for the Pier 5 Scour intervention placement scope of work.

**Catherwood Towing will be providing navigational tug assist, if required, during the intervention scope of work.**



transportation  
investment  
corporation



PATTULLO BRIDGE  
REPLACEMENT



# NAVWARN – January 23-31, 2024

## CONSTRUCTION ACTIVITIES PLANNED:

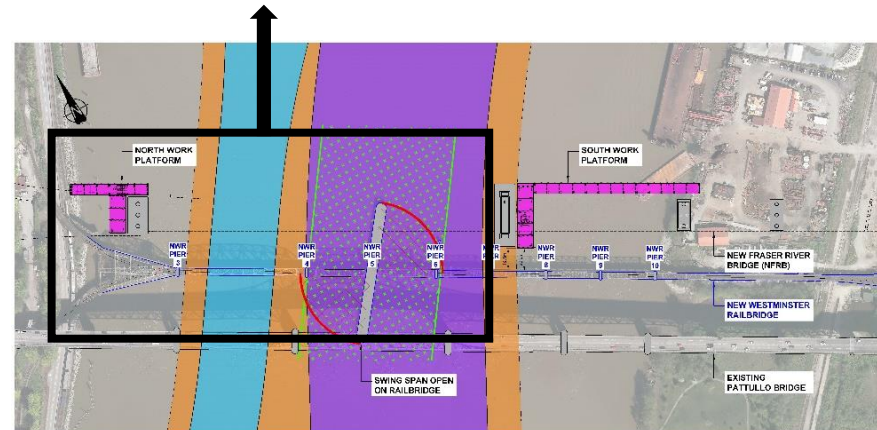
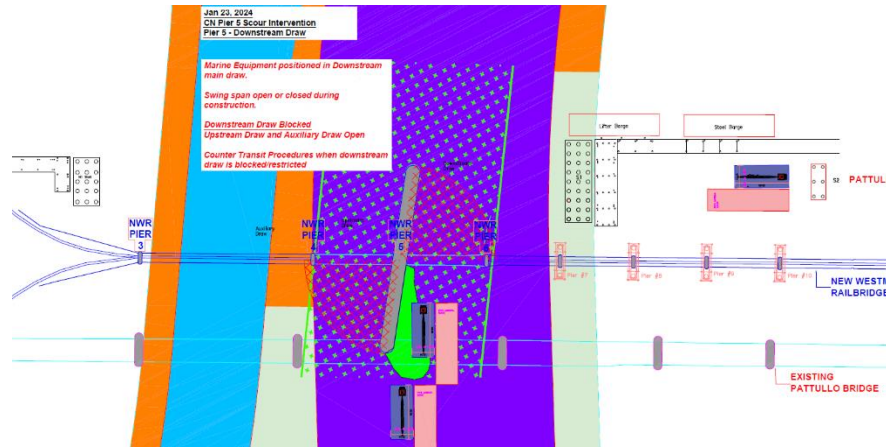

## NAVIGATIONAL RESTRICTIONS:

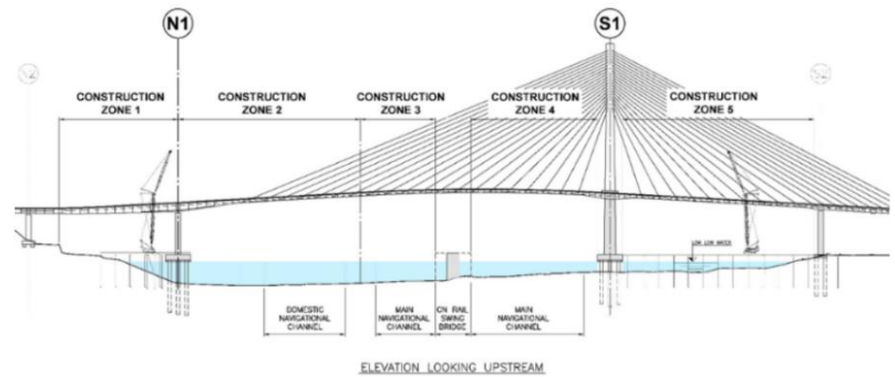

Marine Construction Weekly Update					
Period of January 23-31, 2024	Zone 1 Pier N1 to New Westminster Shoreline	Zone 2 Navigational Channel	Zone 3 Main Navigational Channel Upstream	Zone 4 Main Navigational Channel Downstream	Zone 5 Pier S1 to Surrey Shoreline

Open to All Marine Traffic  
 Open with restricted manageability due to construction activities  
 Closed due to construction activity

### Contact the Project

**24/7 Phone Line**  
 1-844-815-6149

**Project Information**  
[pattullobridgereplacement.ca](http://pattullobridgereplacement.ca)  
[pattullobridgeproject@gov.bc.ca](mailto:pattullobridgeproject@gov.bc.ca)

**Marine Channels**  
 74 General Info  
 16 Marine Emergency

06 Marine Contractor  
 69 Tugs and Crews