

Weekend lane closures on Royal Avenue between McBride Boulevard and Dufferin Street

January 26, 2023

On Saturday, January 28 and Saturday, February 4, additional lane closures will be implemented on Royal Avenue between McBride Boulevard and Dufferin Street so crews can excavate the roadway and install temporary steel road plates for vehicle traffic as part of ongoing rehabilitation work on the Royal Avenue overpass.

The following traffic pattern changes will be implemented while this work is underway:

- **Westbound vehicles on E. Royal Avenue:** The westbound through lane will be closed. All turns to McBride Boulevard will be maintained.
- **Eastbound vehicles on Royal Avenue:** One lane of eastbound through traffic will be maintained.
- **Northbound vehicles on McBride Boulevard:** Northbound left turns to Royal Avenue will not be permitted. Trucks from E. Columbia Street will be detoured to Front Street for westbound travel. General traffic from E. Columbia Street heading for Royal Avenue will continue onto Columbia Street and follow detour signage.
- **Right-in, right-out access to Leopold Place and Bushy Street will generally be maintained;** however, there will be some turning restrictions at Bushby Street. Access will be maintained at Leopold Place.
- **The sidewalk on Royal Avenue will be maintained.**

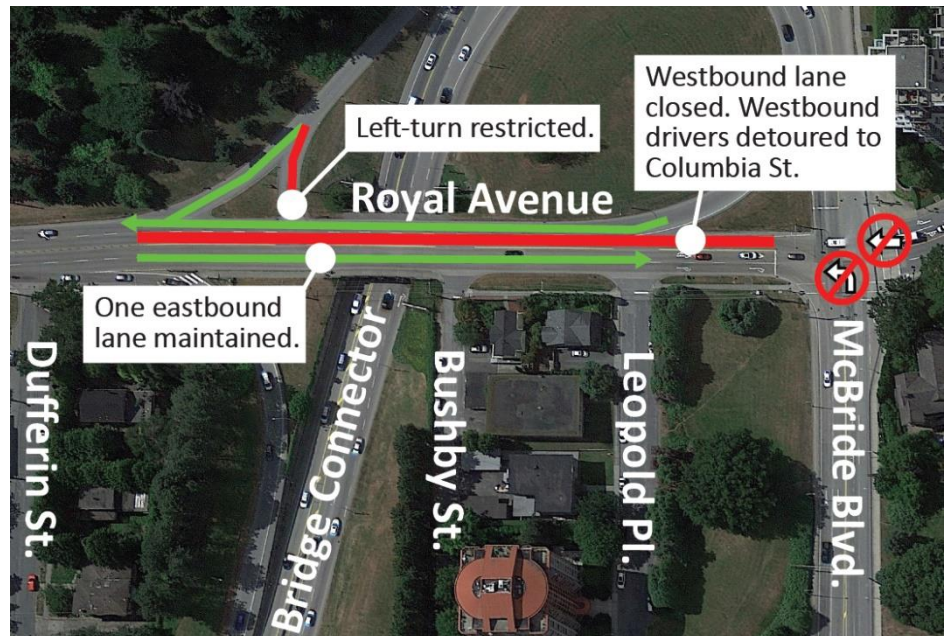

Contact the Project



24/7 Phone Line
1-844-815-6149



Project Information
pattullobridgereplacement.ca
pattullobridgeproject@gov.bc.ca



Work on the Project
bcib.ca
info@bcib.ca



What to Expect



Timing

Saturday, January 28

Saturday, February 4

Two additional weekends will be required to complete this work. An updated notification will be provided in advance.



Hours of Work

Saturday from 7:00 a.m. to 6:00 p.m.

Some non-noisy work may take place after 6:00 p.m. on Saturday.



Traffic

Traffic control personnel will be on site to direct traffic, pedestrians, and cyclists. All traffic pattern changes will be well signed.

The lane closure will be in place:

Saturday from 8:00 a.m. to 6:00 p.m.

When the additional weekends work are required, the lane closures may also be in place on Sunday from 9:00 a.m. to 6:00 p.m.



Impacts/Interruptions

Nearby residents may hear noise from back-up beepers and heavy equipment including an excavator and jackhammer during hours of work.

For more information about traffic pattern changes on Royal Avenue, please [click here](#).

If you have any questions about this work, please email info@fcgcp.ca or call the 24/7 construction information phone line: 1-844-815-6149.

Contact the Project



24/7 Phone Line
1-844-815-6149



Project Information
pattullobridgereplacement.ca
pattullobridgeproject@gov.bc.ca



Work on the Project
bcib.ca
info@bcib.ca