

MCTS Western NAVWARN Issuing Desk

Website: nis.ccg-gcc.gc.ca

Phone: 250-627-3070

Email: NAVWARN.MCTSPrinceRupert@innav.gc.ca

Navigational Warning Request

Organization Name and Contact Number: Fraser River Pile and Dredge (GP) Inc.

Site Name and Contact Number:

FRPD – Jamie Steele – Senior Superintendent – jsteele@frpd.com – 604-315-0125

FRPD – Ken Schulz – Superintendent – kschulz@frpd.com – 604-209-1104

FRPD – Justin Pilgrim – Superintendent – jpilgrim@frpd.com – 604-818-8946 (Night)

FRPD – Mike Logan – Senior Project Manager – mlogan@frpd.com – 604-617-1541

FRPD – Jordan Carriere – Health and Safety Manager – jcarriere@frpd.com – 778-887-3740

FRPD – Stephen Arogundade – Project Manager – sarogundade@frpd.com – 778-554-2660

Start Date and Time: Feb 4, 2022 – 00:01

End Date and Time: Jan 12, 2022 – 24:00 (Weekly issuance) *Or amended due to change in work activities.*

Location of Activity:

Fraser River upstream of the New Westminster Rail Bridge approximate Latitude 49 12' 30", Longitude 122 53' 32". S1 Pier of the New Pattullo Bridge

Brief Description of Work:

S1 Pile Cut-off, Rebar Cage Install, Rebar Support

Hours of Operation:

20 Hours per Shift

Vessels on Site:

FRPD GE2 – 123' x 48' x 8' – Misc. Support

FRPD D. Reid Derrick – Pier S1

Various material barges required to undertake the scope of works, including but not limited to:

- FRPD #15 Barge, RT102, FRPD #8
- FRPD Rupert Barge
- Ocean Barges (Trader, Carrier, Hauler, Delta King) – Pipe / Cages / Concrete

VHF Channel Monitored:

VHF channels to be monitored include:

- Channel 16 for the Canadian Coast Guard – **Emergency**
- Channel 74 for marine traffic in the Fraser River.
- Channel 69 – FRPD Crew(s) Working Channel
- Channel 71 – Alternate FRPD Crew Working Channel

Special Requests or Additional Information:

Reference is made to the attached staging drawing for works from Feb 3-12, 2021.

No restriction to the main navigation channels (Downstream, Upstream or Auxiliary) expected. Barges and derricks will be moored close to the downstream draw.

Temporary Special Operating Procedures to be followed by Marine Traffic and Mariners.

| Temporary Special Operating Procedures (TSOP's) | Notice (minutes) | Communications | Communication Sequencing and VHF Channels |
|---|------------------|---------------------------|--|
| Pre-Call | 60 | Master Call Bridge Tender | Refer to Communications Flow Chart <ul style="list-style-type: none">• VHF Channel 74 General Information• VHF Working Channel 69 (Marine Contractor Marine Flagger)• VHF Channel 16 Emergency Channel |
| ETA Call | 20 | Master Call Bridge Tender | Refer to Communications Flow Chart <ul style="list-style-type: none">• VHF Channel 74 General Information• VHF Working Channel 69 (Marine Contractor Marine Flagger)• VHF Channel 16 Emergency Channel |

The sequencing of actions and the VHF communication responsibilities are outlined in the Corresponding Temporary Special Operating Procedures



NAVWARN – February 4-12, 2022

CONSTRUCTION ACTIVITIES PLANNED:

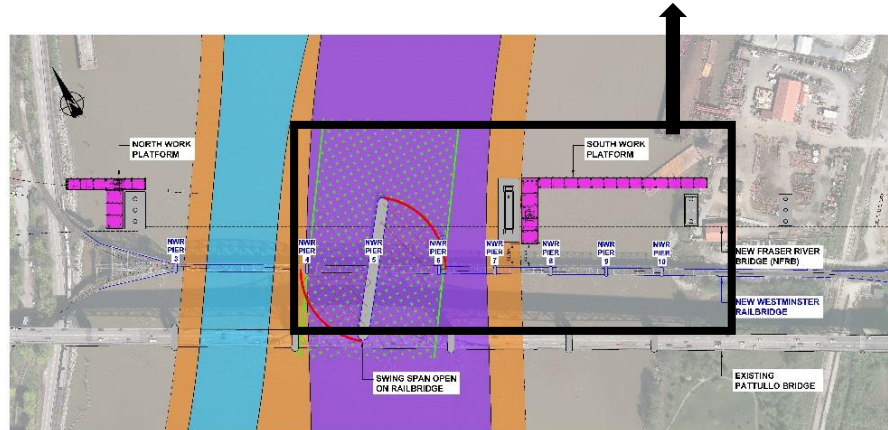
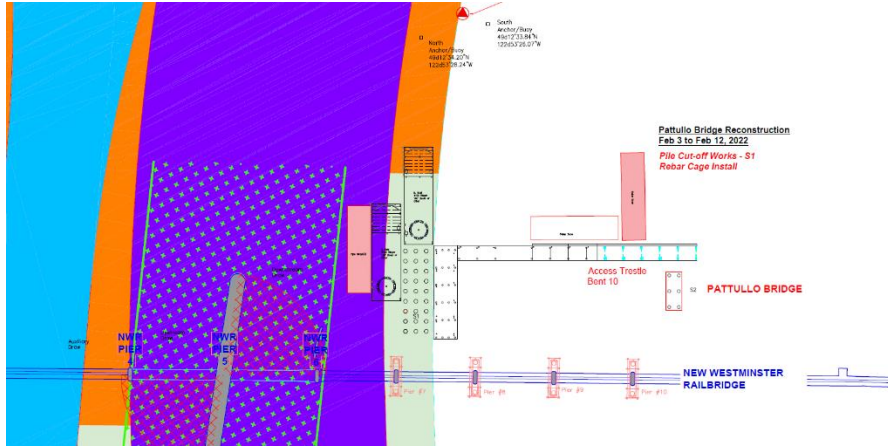

NAVIGATIONAL RESTRICTIONS:

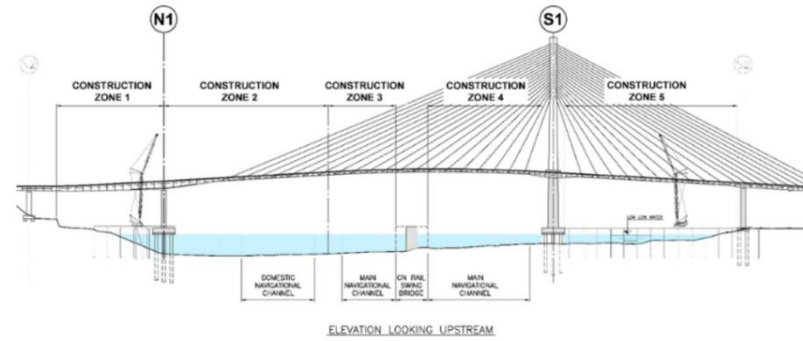

Marine Construction Weekly Update

| Week of February 4-12, 2022 | Zone 1 Pier N1 to New Westminister Shoreline | | Zone 2 Navigational Channel | | Zone 3 Main Navigational Channel Upstream | | Zone 4 Main Navigational Channel Downstream | | Zone 5 Pier S1 to Surrey Shoreline | |
|-----------------------------|---|--------|--------------------------------|--------|--|--------|--|--------|---------------------------------------|--------|
| | Time | Status | Time | Status | Time | Status | Time | Status | Time | Status |
| Friday, February 4 | 24hr | Open | 24hr | Open | 24hr | Open | 24hr | Open | 24hr | Open |
| Saturday, February 5 | 24hr | Open | 24hr | Open | 24hr | Open | 24hr | Open | 24hr | Open |
| Sunday, February 6 | 24hr | Open | 24hr | Open | 24hr | Open | 24hr | Open | 24hr | Open |
| Monday, February 7 | 24hr | Open | 24hr | Open | 24hr | Open | 24hr | Open | 24hr | Open |
| Tuesday, February 8 | 24hr | Open | 24hr | Open | 24hr | Open | 24hr | Open | 24hr | Open |
| Wednesday, February 9 | 24hr | Open | 24hr | Open | 24hr | Open | 24hr | Open | 24hr | Open |
| Thursday, February 10 | 24hr | Open | 24hr | Open | 24hr | Open | 24hr | Open | 24hr | Open |
| Friday, February 11 | 24hr | Open | 24hr | Open | 24hr | Open | 24hr | Open | 24hr | Open |
| Saturday, February 12 | 24hr | Open | 24hr | Open | 24hr | Open | 24hr | Open | 24hr | Open |

■ Open to All Marine Traffic
■ Open with restricted manageability due to construction activities
■ Closed due to construction activity

Contact the Project

24/7 Phone Line
 1-844-815-6149

Project Information
pattullobridgereplacement.ca
pattullobridgeproject@gov.bc.ca

Marine Channels
 74 General Info
 16 Marine Emergency

06 Marine Contractor
 69 Tugs and Crews